

Flat Pattern

t=5

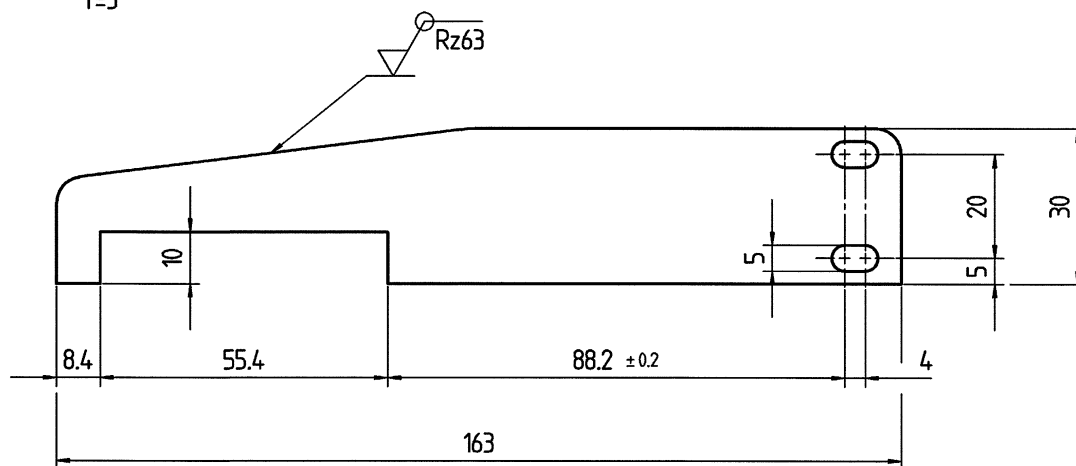

(5)

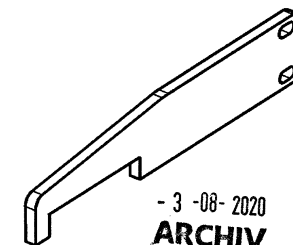
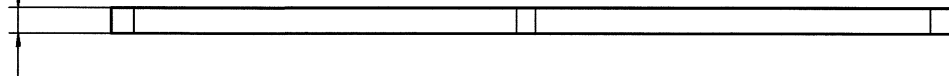

- 3 -08- 2020

ARCHIV

24/20/00352

Non-dimensioned details according to 3D-Data

First angle projection	01	RFQ>PROD	T135098										
General tolerance (GT) in mm	Index		alteration	Change no	Fit								
Size range	PPAP-Level 1 / WN 50020		Material: S235JR		Weight: 0.15								
<table border="1"> <tr> <td>> 30</td> <td>> 120</td> <td>> 400</td> <td>> 1000</td> </tr> <tr> <td>≤ 30</td> <td>≤ 120</td> <td>≤ 400</td> <td>≤ 1000</td> </tr> </table>	> 30	> 120	> 400	> 1000	≤ 30	≤ 120	≤ 400	≤ 1000	Inspection dim. () Aux.dim. ()		Blank no:		
> 30	> 120	> 400	> 1000										
≤ 30	≤ 120	≤ 400	≤ 1000										
GT fine	Date	Name	Title:										
L 0,2 0,5 0,8 2 4	28.10.2019	M.Bolbrinker	sheet metal holder										
Δ 0,1 0,2 0,4 1 2	28.10.2019	M.Bolbrinker	roller channel										
Lengths (L) and angle () = ±GT	Auth'd	A.Ettenhuber	Prod.										
	M.check	C. Weise	Scale										
			1:1										
			1:2										
			Sheet:										
			1										
			of:										
			1										
Languages:		Confidential document	Drawing number										
EN		Refer to protection notice ISO 16016	55044233202										
			Repl.										
			Orig.										

Condition at time of delivery

de-scaled (degree of purity SA 2 1/2 acc. ISO 8501-1)	X
without burrs acc. WN 11310	X
Permissible top-end rounding during flame cutting (also positive bead acc. WN 10572)	-
oil-free / free of grease	X
oiled	-
oiling permissible	-
Indicate the required condition at time of delivery with an X.	

outline length WN 10535

outer	392.9	mm
inner	47.4	mm

Released

3169685/D2D/001/01 A3

55044233202V01END001